



Welcome

Waste Management of Canada Corporation is pleased to introduce an exciting new approach to waste management in the Region:
The *Beechwood Road Environmental Centre*

Please take a few moments to browse the display material and talk to our staff and consultants.





Terms of Reference

The Terms of Reference (referred to as TOR) is the first step in the EA process. The TOR provides a framework (or work plan) for conducting the EA studies and assessing predicted impacts of the project. The TOR will be submitted to the Minister of the Environment for approval consideration. Once approved, the TOR specifies how the EA studies will be conducted.

- For the proposed Beechwood Road Environmental Centre (BREC) facility, only the landfill that is intended to receive residual wastes, which cannot be recycled or reused, is subject to an EA under the Ontario *Environmental Assessment Act*.
- Other facility components of the BREC, such as materials recycling facility, construction and demolition materials facility, and organics processing facility, require government approvals such as Certificate of Approval.
- Components, such as Waste Electrical and Electronics Equipment (WEEE) and Public Drop-off Facility for recyclable materials, have already been implemented.
- The EA process for new or expanded landfills begins with a Notice of Commencement of the EA and development of a Terms of Reference (TOR).
- The proposed TOR will be drafted by WMCC in consultation with the Ministry of the Environment, surrounding communities and interested parties.
- The decision to approve or reject the TOR, or approve the TOR with conditions, is made by the Minister of the Environment.
- Public input and consultation is an important part of the development of the Terms of Reference.





Submitting the TOR

The Terms of Reference will be submitted to the Ministry of the Environment for approval. Once approved the TOR provides the framework for conducting and evaluating the EA.

- The TOR comprises three volumes:
 - Volume 1 – Terms of Reference and Appendices
 - Volume 2 – Consultation Record
 - Volume 3 – Supporting Documents to the TOR
- The MOE will make the TOR available to the public for review for a 30 day period
- Copies of the TOR will be submitted to the MOE and Government Review Team
- Copies of the TOR will be available on the project website and in local libraries
- Comments received by the Ministry during the comment period will be forwarded to WM for response
- The Ministry is expected to provide a decision on the Terms of Reference in 12 weeks





How the EA will be prepared

The proposed TOR will be submitted to the Minister for approval in accordance with the Ontario *Environmental Assessment Act* (EAA) and Regulation 101/07.

- The EA will be a “full or “individual” EA under the Ontario EAA
- The EA will be ‘focused’ pursuant to subsection 6(2)(c) and 6.1(3) of the EAA
- The following will not be included in the EA;
 - A description of and statement of the rationale for the undertaking (i.e., the need for the project), and
 - A description of and statement of the rationale for alternatives to the undertaking
- The determination of the need for WM's services in eastern Ontario and alternatives to the undertaking were made by WM based on business analyses and decisions. The assessment are summarized in the TOR and included in a Supporting Document to the TOR
- The EA will include additional assessments not normally included in an Ontario EA. These include:
 - Assessment of cumulative effects;
 - Consideration of valued ecosystem components; and
 - Assessment of the effects of the environment on the project
- The inclusion of cumulative effects will address concerns heard during the consultation process about considering the effects of all components of BREC (and other projects too) as well as making the EA process more compatible with the federal EA process





Contents of the TOR

The proposed TOR will be submitted to the Minister in three volumes.

Volume 1: The Main TOR Document and Contains:

- **Section 1** - an introduction to the TOR including the purpose and organization of the TOR;
- **Section 2** - historical context for the current proposal including an overview of the previous EA and the issues related to that undertaking;
- **Section 3** - an overview of the analysis to determine if there was a need for the undertaking, and identification of alternative methods of implementing the proposed undertaking;
- **Section 4** - an overview of the environment that may be affected by the proposed undertaking and a description of study areas that will be used to characterize existing environmental conditions and to conduct the assessment of effects;
- **Section 5** - an overview of the proposed methods for conducting the comparative evaluation of alternatives, including a discussion of proposed mitigation measures;
- **Section 6** - summary of results of consultation during development of the TOR and proposed consultation plan for the EA;
- **Section 7** - the proposed schedule for preparing the EA;
- **Appendices** – additional detailed information

Volume 2: Consultation Record presents the record of the consultation process, summary of events, inputs received, how input was used in the TOR or rationale for why it wasn't considered appropriate for inclusion in the TOR;

Volume 3: Supporting Documents – additional analysis and studies.





EA Work Plans

WM submitted the proposed work plan for the environmental assessment (EA) of new landfill footprint at the existing Napanee site to the members of the Government Review Team (GRT). The EA work plan is part of the TOR that will be submitted to the MOE for approval.

- The proposed work plan, which is part of the TOR, presents the scope of work required to complete the EA, including the scope of technical studies for each of the environmental components, public consultation, effects prediction/assessment, mitigation, EA documentation and submission.
- The work plan also presents proposed schedules for the technical studies.
- The work plan documentation was distributed to 35 members of the GRT representing various Federal Agencies, Ministries, Conservation Authorities and other government interest groups.
 - County of Hastings
 - County of Lennox & Addington
 - Department of Fisheries and Oceans
 - Hydro One Networks Inc.
 - Ministries of Citizenship and Immigration, Culture, Tourism and Health Promotion
 - Ministry of Agriculture, Food and Rural Affairs
 - Ministry of Culture
 - Ministry of Energy and Infrastructure
 - Ministry of Health Promotion
 - Ministry of Municipal Affairs & Housing Community Planning and Development
 - Ministry of Natural Resources
 - Ministry of the Environment
 - Ministry of Tourism
 - Ministry of Transportation
 - Ministry of Transportation
 - Ontario Power Generation
 - Ontario Realty Corporation
 - Quinte Conservation
 - Town of Greater Napanee
 - Township of Tyendinaga
 - Transport Canada





Study Areas

Data for the EA will be collected and analyzed for three generic study areas that will be presented in the TOR.

Study Areas

- On-site – the lands owned and/or optioned by WM for the proposed new landfill footprint;
- Site Vicinity – the lands in the vicinity of the Napanee Landfill (within 500 metres (m) of the alternative Napanee Landfill waste footprints, which will be developed during the EA); and
- Regional – the lands within about 25 km of the Site for socio-economic environment.

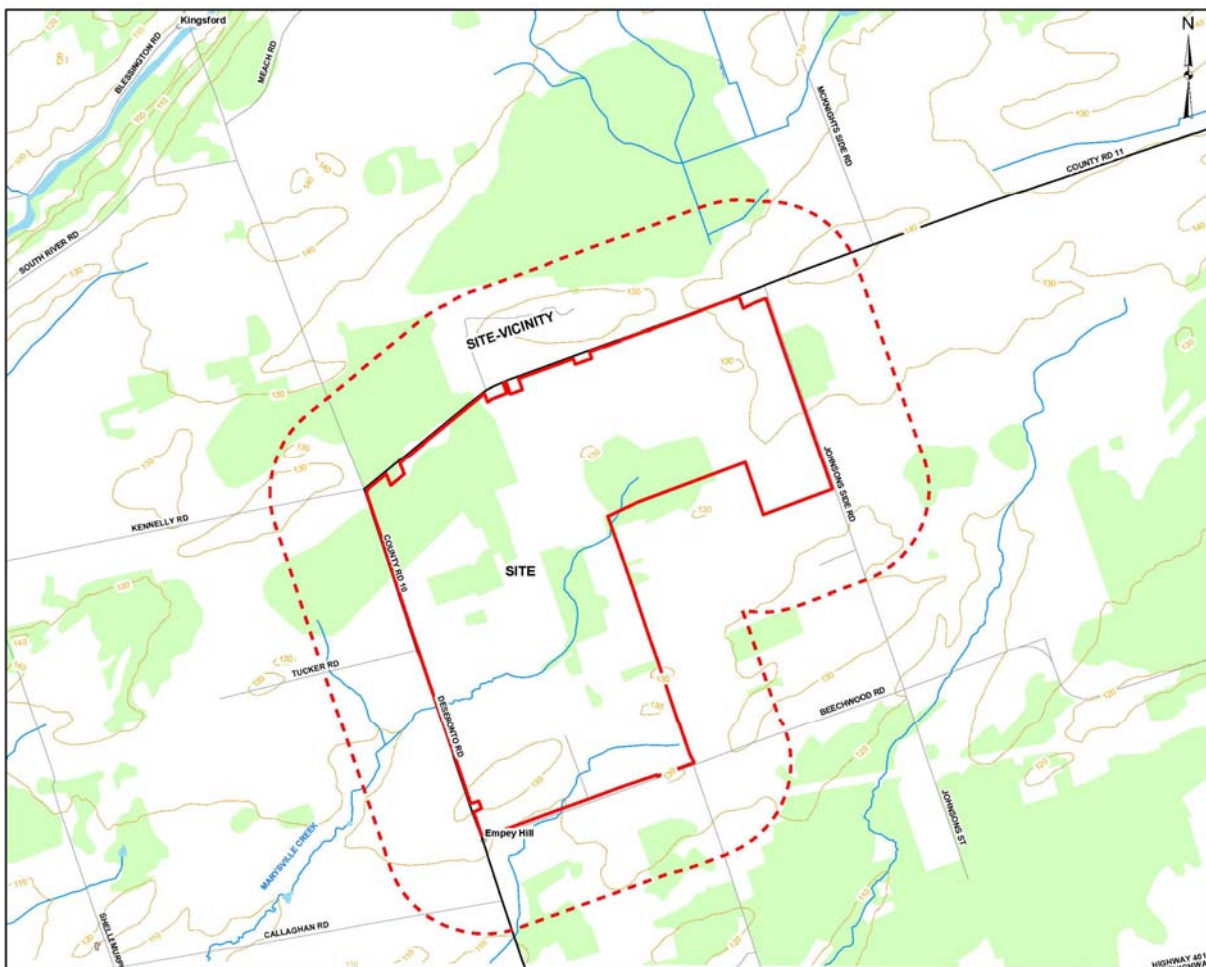



EA Approach and Environmental Components

This proposed work plan, which is part of the TOR, presents the scope of work required to complete the EA, including the scope of technical studies for each of the environmental components, public consultation, effects prediction/assessment, mitigation, EA documentation and submission. The work plan also presents proposed schedules for the technical studies.

Phased Approach

It is proposed that the EA work will be undertaken in three phases as follows:

- Phase 1 – Characterize Existing Environment and Predict Effects of the Proposed Alternatives;
- Phase 2 – Identify Preferred Alternative; and
- Phase 3 – Prepare and Submit EA Documentation.

Consultation with the public, agencies and other stakeholders will be ongoing throughout the EA process.

Environmental Components

The environmental components that will be evaluated in the EA are as follows:

Environmental Components	Technical Criteria
Atmospheric	Site Design and Operations
Geology and Hydrogeology	
Surface Water	
Biology	
Cultural Heritage Resources	
Transportation	
Land Use	
Agriculture	
Socio-economic	
Aboriginal	



Time Frame

The EA will consider potential effects on the environment associated within following three timeframes:

- Construction;
- Operations (20 years); and
- Post-closure.





Feedback from Open House #1 March 10, 2010

Open House #1 had 50 attendees including neighbours, businesses, agencies, municipal councillors, media representatives and members of the general public. The feedback received is summarized below.

Open House information:

- It laid the foundation .. gave me a good understanding of this new starting point.
- Good layout of posters, needs more posters on criteria/impacts on community (as for your possible assessment criteria).
- Lots of info, well laid-out, way better plan than before.
- Adequate overall preview, disappointing lack of specifics, and few clear answers regarding WM financial decisions/exposure/risk aversion.

Proposed project and process:

- I am impressed with the ideas put forth regarding changes at the landfill. Lots of forward thinking involved.
- I'm happy with the process... only hoping that there won't be a lot of opposition by people who have made up their minds and don't want to listen to the facts.

Proposed evaluation criteria:

- Very important criteria included air quality, land ecosystems, groundwater quality, and surface water quality.
- Important criteria include noise, visual impacts, cultural heritage and archaeological resources.
- Westerly options preferred over easterly options since they are closer to the Deseronto Road, which is better from a transportation perspective. Westerly options are preferred from a visual impact perspective as the landfill will be sheltered by the wetland conservation area to the north, existing closed landfill site to the south and other wooded areas/open land to the west.

General Comments

- Concerned about the potential odours from the composting process and whether the process can be moved inside to mitigate air problems through filtering.





Feedback from Workshop March 25, 2010

The Workshop had 21 attendees including neighbours, businesses, agencies, municipal councillors, media representatives and members of the general public. The feedback received is summarized below.

Need for a new landfill footprint:

- General agreement that there is a need for more waste disposal capacity in Eastern Ontario.
- Waste needs to go somewhere – shipping waste across the border is not a solution. What happens when the border closes to waste?
- What will happen if there is no capacity to take garbage in Ontario?
- Taking trash across the border costs money – very heavy burden on the taxpayer.
- People should have to pay more for waste disposal services – there would be better diversion rates as a result.
- BREC can be a regional centre of excellence, a model for other waste centres.
- It is better if waste goes to an organized centre such as BREC instead of it going to a larger number of small municipal sites, since BREC will be much better equipped to sort, recycle and divert waste from a landfill. The smaller sites don't do much recycling and are not well-managed.
- An increase of 1.5 to 2% per year might be hard to achieve – progress may be slow.
- What does “aggressive diversion” mean? Is a 2% annual increase in diversion realistic and achievable? Where did that number come from?
- Why haven't more sites been created?
- Why is less landfill capacity being sought in this project versus the previous project, if landfill needs in Eastern Ontario could potentially increase.
- Has the closure of municipal landfill sites been considered, like the two landfills in Stone Mills that are reaching capacity?





Feedback from Workshop March 25, 2010

Alternatives to a new landfill footprint:

- There was general agreement that the 'alternatives to' assessment was adequate – no other factors were identified that need to be considered.
- What about incineration – is that an option?
- There was general agreement that alternative 6 (new landfill footprint with enhanced diversion) was preferred.
- Everyone produces waste and no one wants to deal with it – someone needs to take responsibility.
- Saw a documentary on a landfill site in BC – we need tougher regulations passed so that we are forced to deal with our own waste.
- The Province should step in and take responsibility and pass an Act that says how it should be done and it should be imposed on Ontario that we have to take care of our own garbage.
- This process is going to be better than the last process.





Feedback from Workshop March 25, 2010

Alternatives methods for a new landfill footprint:

- There was general agreement that the information presented and the analysis undertaken to determine the most suitable land envelope for the new landfill footprint was understandable and appropriate.
- The land area (envelope) identified is appropriate because of visual appearance considerations, accessibility, and availability of land.
- There was considerable discussion about different configurations within the identified envelope such as extending the existing landfill to the east, increasing the height and various footprint shapes.
- The group felt that they do not like symmetrical objects and it is preferred for the area to be developed to blend with the surrounding area, and encourage public uses.
- Buffer zones should be in addition to the 50 – 55 ha landfill footprint.
- The alternatives for the new landfill footprint should be identified and evaluated in the EA process.
- The cost of landfill liner and different landfill orientations should be identified and evaluated in the EA process.
- Encouraging public use on the site could help promote the project because that would help people realize that the Site is being operated in an environmentally healthy manner and it is much more safer than what the opposition is making it out to be.

